

**CONDITIONS :-**

- 1) PROVISION FOR RAIN WATER HARVESTING SHOULD BE MADE.
- 2) PROVISION FOR DUAL PIPING SYSTEM SHOULD BE MADE FOR POTABLE WATER & NON POTABLE WATER.
- 3) PROVISION FOR S. T. P. SHOULD BE MADE & RE-CYCLED WATER SHOULD BE UTILIZED & ENTIRE EFFLUENT GENERATED SHOULD NOT BE DISCHARGED TO THE NATURAL VALLEY / STREAM / TANK.
- 4) APPLICANT SHOULD ABIDE BY THE CONDITIONS AS STIPULATED IN THE LETTER ISSUED BY THE PRINCIPAL SECRETARY, LABOUR DEPARTMENT DT. : 04 - 03 - 2006.
- 5) APPLICANT SHALL ABIDE BY THE CONDITIONS AS STIPULATED IN THE C A SITE LEASE AGREEMENT EXECUTED BY B D A.
- 6) APPLICANT SHALL MAKE THEIR OWN ARRANGEMENTS FOR WATER SUPPLY & WILL NOT DEPEND ON BYSSR FOR SUPPLY OF WATER.
- 7) APPLICANT SHALL ABIDE BY THE CONDITIONS AS & WHEN IMPOSED BY B D A.
- 8) THE MODIFIED PLAN SANCTIONED SUPERCEDES THE EARLIER SANCTIONED PLAN

VIDE NO. BDA / PS / EM / EO2 / CA / NORTH / 22 / 07 - 08 DT. : 11 - 01 - 2008

A) THE MODIFIED BUILDING PLAN HAS BEEN APPROVED BY THE HON'BLE COMMISSIONER VIDE NO. : 871, DT. : 27 - 4 - 2008
B) THE APPLICANT HAS PAID THE PLAN SANCTIONING FEES VIDE CHALLAN NO. : 2132 DT. : 16 - 11 - 2007 & CHALLAN NO. : 7514 DT. : 05 - 05 - 2008 ARE AS FOLLOWS
1) PLAN PROCESSING FEES :- RS. 96,460.00
2) GROUND RENT :- RS. 1,54,336.00
3) DEVELOPMENT CHARGES :- RS. 96,460.00
4) SLUM CLEARANCE CESS :- RS. 16,080.00
5) WORKER'S WELFARE CESS :- RS. 6,22,746.00
6) SECURITY DEPOSIT :- RS. 9,64,600.00
7) PLAN COPIES CHARGES :- RS. 7,500.00
<b>TOTAL AMOUNT :- RS. 19,58,102.00</b>
PAID DURING EARLIER SANCTIONED PLAN :- RS. 15,50,058.00
PAID DURING MODIFIED SANCTIONED PLAN :- RS. 4,08,094.00
<b>TOTAL AMOUNT :- RS. 19,58,182.00</b>
<b>TOTAL AMOUNT :- RUPEES NINETEEN LAKS, FIFTY EIGHT THOUSANDS AND ONE HUNDRED AND EIGHTY TWO ONLY.</b>

ಇವುಗಳನ್ನು 21.05.2008 ರಂದು 2008 ರಲ್ಲಿ ಸರ್ಕಾರದ ಅಧಿಕಾರಿಗಳಿಂದ ಪರಿಶೀಲಿಸಿ ಮತ್ತು ಅನುಮೋದಿಸಿ (21/05/08 ರಿಂದ 20/05/2008) ವರೆಗೆ ವಾಸ್ತು ವಿನ್ಯಾಸಕ್ಕೆ ಅನುಮೋದನೆ.

21/05/08

SCHEDULE OF OPENINGS		SPECIFICATIONS		NORTH	CLIENT NEW HORIZON EDUCATIONAL INSTITUTE	PROJECT MODIFIED PROPOSED EDUCATIONAL INSTITUTE ON CA SITE NO : 7 P 1 B 2ND MAIN, JRD A CROSS, EAST OF ASET LAYOUT BANGALORE	SCALE 1:100	DATE 10.07.09	OWNER'S SIGNATURE	ARCHITECT'S SIGNATURE	PRINCIPAL ARCHITECTS ACE GROUP 300, 1ST FLOOR ARCHITECTS SANKARIN COMPLEX CONSULTING BANGALORE ROAD BANGALORE - 25 PHONE: 2222298, 22221664 e-mail: acegroup@rediffmail.com FAX: 22225952 website: www.acegrouparchitects.com
0	2450 x 2125	ROOFTOP DOOR	SUBSTRUCTURE :- RCC FOOTINGS AND RCC PERIMETER WALL								
01	1600 x 2425	ROOM DOOR	SUPERSTRUCTURE :- RCC FRAMED STRUCTURE WITH WALLS & SOLID / HOLLOW CEMENT BLOCK MASONRY IN CM 1:4								
02	1200 x 2125	ROOF DOOR	ROOF :- RCC ROOF SLAB WITH SURGE LAD TO SLOPE SLOPE FINISHED IN CM 1:6 WITH WATER PROOFING STEEL ROOF TRUSS WITH FEPS SHEET ROOF COVERING								
03	500 x 2625	SCREEN DOOR	DOORS AND WINDOWS :- WOOD / METAL								
04	2000x1000	NET, ET DOOR	FLOORING :- MOSAIC								
05	1200x1200	WINDOW	FINISHES :- PLASTERING IN CM 1:6								
06	2100 x 200	STAIR DOOR	PAINTING :- WATER PROOF CEMENT PAINT FOR EXTERNAL SURFACE, OIL BASED EMULSION PAINT FOR INTERNAL SURFACE								
07	500 x 500	VENTILATOR									

FIRST FLOOR PLAN



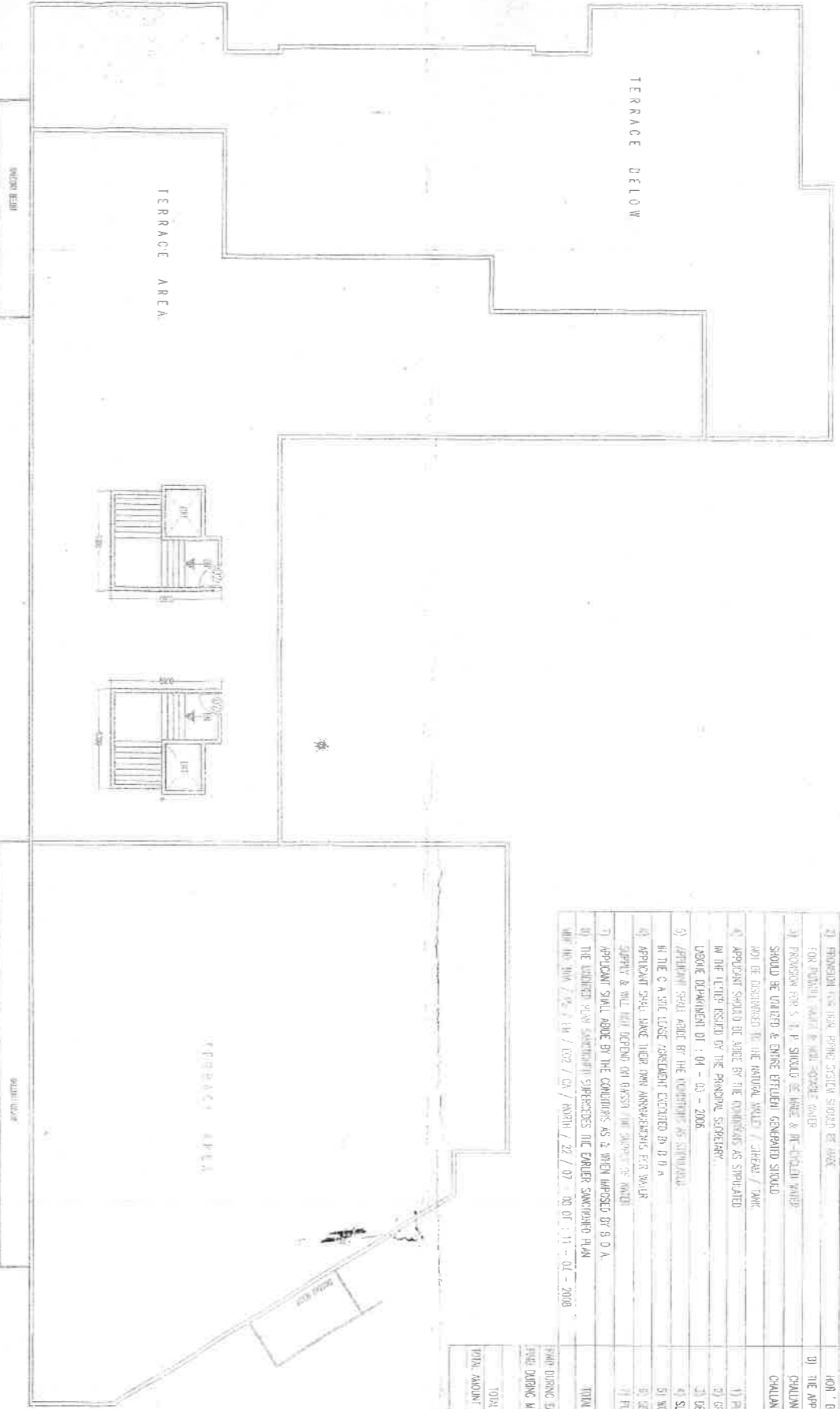

**TERRACE FLOOR PLAN**

**CONDITIONS**

- 1) PROVISION FOR RAIN WATER INFILTRATION SHOULD BE MADE
- 2) PROVISION FOR BASE FLOOR SHOULD BE MADE
- 3) FOR PAVEMENT UNDER THE TERRACE SHOULD BE MADE
- 4) PROVISION FOR S.P.P. SHOULD BE MADE & THE TYPICAL WATER SHOULD BE QUOTED & GIVE EVIDENCE GENERATED SHOULD NOT BE DISTRIBUTED TO THE NATIONAL WATER / CHEMICAL / WATER
- 5) APPROVAL SHOULD BE MADE BY THE COMPETENT AS STIPULATED IN THE TERMS REFERRED TO THE PRINCIPAL SUPERVISOR
- 6) APPROVAL SHALL MADE BY THE COMPETENT AS STIPULATED IN THE TERMS REFERRED TO THE PRINCIPAL SUPERVISOR
- 7) APPROVAL SHALL MADE BY THE COMPETENT AS STIPULATED IN THE TERMS REFERRED TO THE PRINCIPAL SUPERVISOR
- 8) APPROVAL SHALL MADE BY THE COMPETENT AS STIPULATED IN THE TERMS REFERRED TO THE PRINCIPAL SUPERVISOR
- 9) APPROVAL SHALL MADE BY THE COMPETENT AS STIPULATED IN THE TERMS REFERRED TO THE PRINCIPAL SUPERVISOR
- 10) APPROVAL SHALL MADE BY THE COMPETENT AS STIPULATED IN THE TERMS REFERRED TO THE PRINCIPAL SUPERVISOR
- 11) APPROVAL SHALL MADE BY THE COMPETENT AS STIPULATED IN THE TERMS REFERRED TO THE PRINCIPAL SUPERVISOR
- 12) APPROVAL SHALL MADE BY THE COMPETENT AS STIPULATED IN THE TERMS REFERRED TO THE PRINCIPAL SUPERVISOR
- 13) APPROVAL SHALL MADE BY THE COMPETENT AS STIPULATED IN THE TERMS REFERRED TO THE PRINCIPAL SUPERVISOR
- 14) APPROVAL SHALL MADE BY THE COMPETENT AS STIPULATED IN THE TERMS REFERRED TO THE PRINCIPAL SUPERVISOR
- 15) APPROVAL SHALL MADE BY THE COMPETENT AS STIPULATED IN THE TERMS REFERRED TO THE PRINCIPAL SUPERVISOR
- 16) APPROVAL SHALL MADE BY THE COMPETENT AS STIPULATED IN THE TERMS REFERRED TO THE PRINCIPAL SUPERVISOR
- 17) APPROVAL SHALL MADE BY THE COMPETENT AS STIPULATED IN THE TERMS REFERRED TO THE PRINCIPAL SUPERVISOR
- 18) APPROVAL SHALL MADE BY THE COMPETENT AS STIPULATED IN THE TERMS REFERRED TO THE PRINCIPAL SUPERVISOR
- 19) APPROVAL SHALL MADE BY THE COMPETENT AS STIPULATED IN THE TERMS REFERRED TO THE PRINCIPAL SUPERVISOR
- 20) APPROVAL SHALL MADE BY THE COMPETENT AS STIPULATED IN THE TERMS REFERRED TO THE PRINCIPAL SUPERVISOR

**TONNAGE**

TONNAGE ADDED - RS. 15,000,000.00

TONNAGE ADDED - RS. 4,000,000.00

TONNAGE ADDED - RS. 1,000,000.00

TONNAGE ADDED - RS. 500,000.00

TONNAGE ADDED - RS. 250,000.00

TONNAGE ADDED - RS. 125,000.00

TONNAGE ADDED - RS. 62,500.00

TONNAGE ADDED - RS. 31,250.00

TONNAGE ADDED - RS. 15,625.00

TONNAGE ADDED - RS. 7,812.50

TONNAGE ADDED - RS. 3,906.25

TONNAGE ADDED - RS. 1,953.12

TONNAGE ADDED - RS. 976.56

TONNAGE ADDED - RS. 488.28

TONNAGE ADDED - RS. 244.14

TONNAGE ADDED - RS. 122.07

TONNAGE ADDED - RS. 61.04

TONNAGE ADDED - RS. 30.52

TONNAGE ADDED - RS. 15.26

TONNAGE ADDED - RS. 7.63

TONNAGE ADDED - RS. 3.81

TONNAGE ADDED - RS. 1.91

TONNAGE ADDED - RS. 0.95

TONNAGE ADDED - RS. 0.47

TONNAGE ADDED - RS. 0.24

TONNAGE ADDED - RS. 0.12

TONNAGE ADDED - RS. 0.06

TONNAGE ADDED - RS. 0.03

TONNAGE ADDED - RS. 0.01

TONNAGE ADDED - RS. 0.00

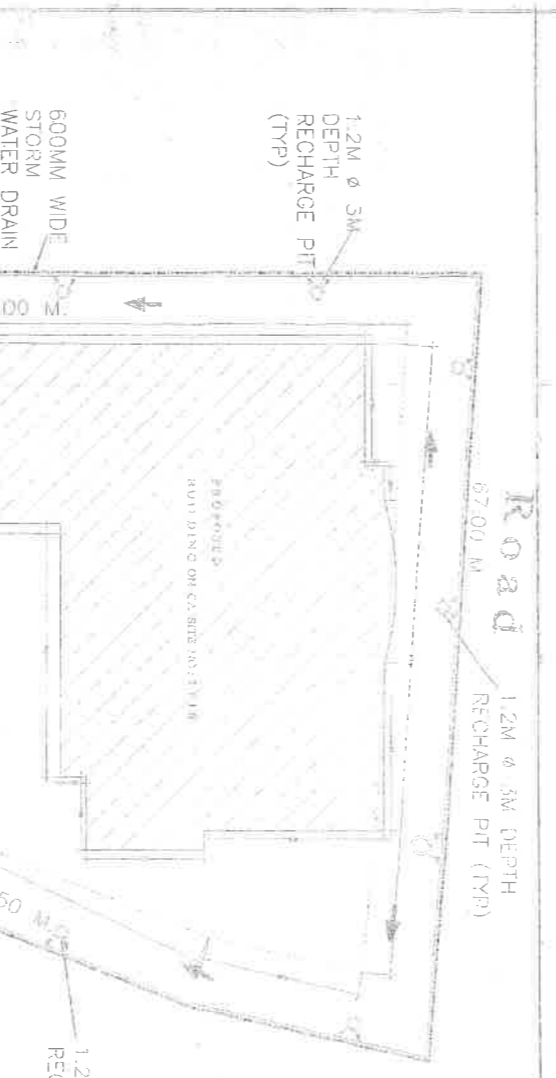

**C.A. SITE NO. 7 P.I.A.**



**SITE PLAN**

SCALE: 1:200

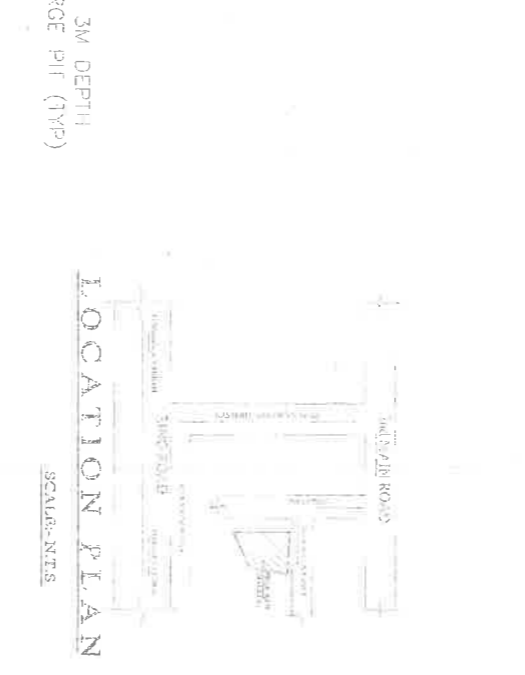

**LOCATION PLAN**

SCALE: N.T.S.

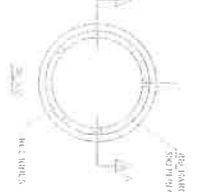

**SCHEDULE OF OPENINGS**

NO.	DESCRIPTION	AREA (SQ. M)	PERIMETER (M)	REMARKS
1	DOOR	1.20 x 2.10	6.60	
2	WINDOW	1.20 x 1.50	5.40	
3	VENTILATOR	0.60 x 0.60	2.40	
4	STAIRCASE	2.10 x 2.10	8.40	
5	TOILET	1.20 x 1.20	4.80	
6	BATH	1.20 x 1.20	4.80	
7	KITCHEN	2.10 x 2.10	8.40	
8	DINING	2.10 x 2.10	8.40	
9	LIVING	3.00 x 3.00	12.00	
10	BED ROOM	3.00 x 3.00	12.00	
11	BED ROOM	3.00 x 3.00	12.00	
12	BED ROOM	3.00 x 3.00	12.00	
13	BED ROOM	3.00 x 3.00	12.00	
14	BED ROOM	3.00 x 3.00	12.00	
15	BED ROOM	3.00 x 3.00	12.00	
16	BED ROOM	3.00 x 3.00	12.00	
17	BED ROOM	3.00 x 3.00	12.00	
18	BED ROOM	3.00 x 3.00	12.00	
19	BED ROOM	3.00 x 3.00	12.00	
20	BED ROOM	3.00 x 3.00	12.00	
21	BED ROOM	3.00 x 3.00	12.00	
22	BED ROOM	3.00 x 3.00	12.00	
23	BED ROOM	3.00 x 3.00	12.00	
24	BED ROOM	3.00 x 3.00	12.00	
25	BED ROOM	3.00 x 3.00	12.00	
26	BED ROOM	3.00 x 3.00	12.00	
27	BED ROOM	3.00 x 3.00	12.00	
28	BED ROOM	3.00 x 3.00	12.00	
29	BED ROOM	3.00 x 3.00	12.00	
30	BED ROOM	3.00 x 3.00	12.00	

**PROJECT INFORMATION**

**CLIENT:** [Name]

**PROJECT:** [Name]

**LOCATION:** [Address]

**DATE:** [Date]

**SCALE:** [Scale]

**DESIGNER:** [Name]

**ARCHITECT:** [Name]

**ENGINEER:** [Name]

**REGISTRATION NO.:** [Number]

**PROFESSIONAL SEAL:** [Seal]

**APPROVAL:** [Signature]

**DATE:** [Date]

**REVISIONS:**

NO.	DESCRIPTION	DATE
1	[Revision]	[Date]
2	[Revision]	[Date]
3	[Revision]	[Date]
4	[Revision]	[Date]
5	[Revision]	[Date]
6	[Revision]	[Date]
7	[Revision]	[Date]
8	[Revision]	[Date]
9	[Revision]	[Date]
10	[Revision]	[Date]